

Instruction manual for the PowerTank XXL

Thank you for purchasing the PowerTank XXL. **IMPORTANT:** Please read these instructions carefully **BEFORE** first use. We recommend to keep this manual for future reference.

1. The PowerTank XXL

The PowerTank XXL is a portable, state-of-the-art storage battery for particular use with electronic devices such as cellular phones, navigation systems, mp3-players, the iPod, iPhone, iPad, Netbooks/Subnotebooks and many more. It is also usable with battery rechargers for rechargeable batteries of the type AA Mignon and AAA Micro as well as for a high variety of camping lights/headlights and rechargers of digital cameras and camcorders.

2. The Technology behind Powertank XXL

This high-capacity product is designed and developed in close cooperation of SStech AG (Switzerland) with leading outdoor experts. The PowerTank XXL consists of state-of-the-art parts and components and is a highly versatile device capable of fully automated selfsupervision and self-control. That's why it's so easy to use.

3. Scope of delivery

Along with the PowerTank XXL comes a variety of useful accessory parts for you to benefit from the full function range of the storage battery.

The delivery includes:

A PowerTank storage battery / battery pack / cigarette lighter adapter electronics for power-driven vehicles including both, an 15V power outlet next to an 5V USB socket.

B The 100-240 volt and 50/60 hertz power adapter to charge the PowerTank XXL at any power socket worldwide

C A car cigar jack connection cable for 12-15V connections in a car, plane or to compatible 15-16V solar modules .

D An USB cellphone charging cable with 4 different adapter plugs

E The popular and easy-to-use charger "P1" for rechargeable batteries including 2 pieces of AA Mignon and 2 pieces of AAA Micro accubatteries

F A separate USB data- and recharging cable for the iPod,iPhone or iPad

G The additional USB car adapter for the iPad

H An versatile charging unit developed especially for netbooks and subnotebooks of 12-30V including 10 different connection adapters **Q**

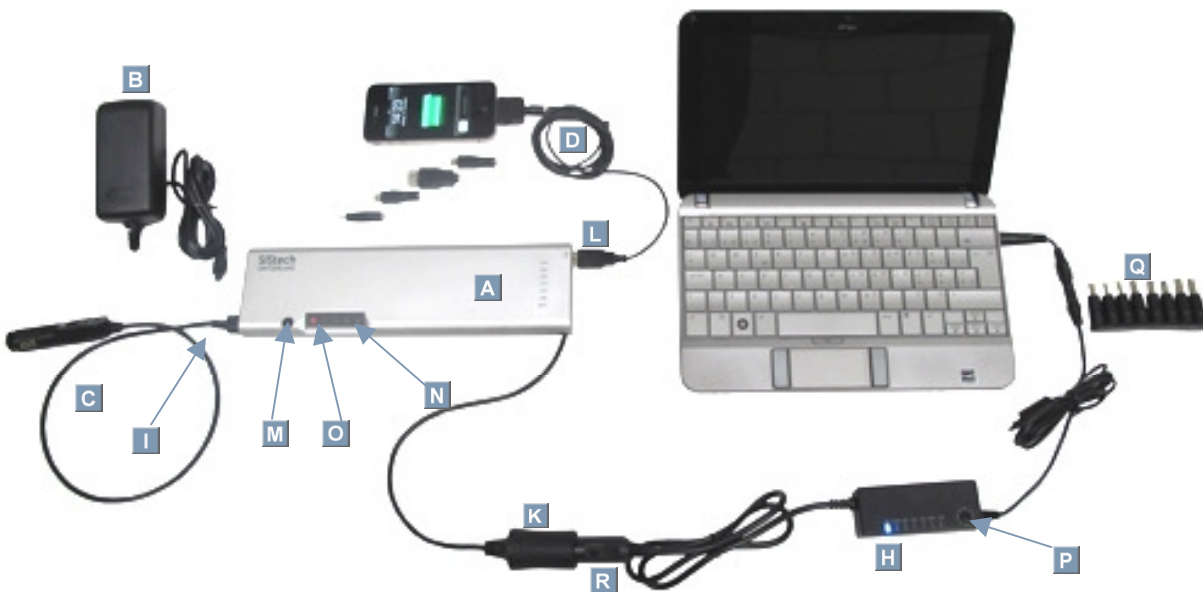

4. Connections and control elements

The PowerTank XXL offers the following connection ports and control elements:

I Connection socket for the regular power adapter or the cigarette lighter cable to charge the PowerTank XXL

K Cigarette lighter socket for connections of 12-15V/5 ampere specified gadgets

L USB socket 5V / 1A for connection/charging of cellular phones, navigation systems, the iPod, iPhone, AA/AAA battery chargers and many others – including a specific connection cable as well as a variety of connection adapters

M Either an on/off button (press at least 3 seconds) or a battery status indicator (press the same button for about 1 second)

N An LED capacity indicator (battery symbols) as well as a red LED indicating the on/off status **O**

5. Startup procedure / initial preparation

Please follow these instructions whenever you are about to use the PowerTank:

First, connect the power adapter or the car cigar jack to the matching socket on the left. **I** The battery symbols **N** indicate the ongoing charging process by continuous flashing.

Once the flashing stops and all battery symbols gleam, the internal battery is full. Now you can disconnect the charging unit and turn off the PowerTank XXL by pressing the M-button **M** for at least 2 seconds. The red on/off indicator LED **O** goes off. Please switch off the PowerTank whenever it's not in use to prevent the control electronics of wasting the stored energy.

PLEASE NOTE: You have to switch the PowerTank **ON, PRIOR** to the connection of any electric consumers!

6. Operating the PowerTank XXL with a netbook / subnotebook

For the particular case of netbook / subnotebook operation of the PowerTank please use the voltage converter unit **H** included in the delivery. It consists of dedicated charging and power supply electronics and may completely substitute the power adaptor unit you used for the netbook before. For safe operation, please follow the steps below:

First of all, check the original power supply unit or the manual of your netbook/subnotebook for the right charging voltage and shift **P** the rotary switch located on top of the voltage converter unit to the corresponding position. Then connect the voltage converter to the PowerTank and check the blue indicator LED for the right voltage settings. Now you can choose the right adapter plug **Q** for your netbook and **H** connect it to the voltage converter unit.

We highly recommend to proceed in the order as listed below.

6.1. Start up the PowerTank XXL by pressing the O-button for at least 2 seconds

6.2. Connect the voltage converter unit to the cigarette lighter socket **K**

6.3. ONLY THEN connect your netbook / subnotebook to the arranged power supply

In case you are not following the proper sequence as described above, the current limiting fuse that protects the voltage converter unit may blow and you will have to replace it (6A). This fuse is located within the tip of the cigarette lighter jack you'll need to screw off. NEVER EVER try to connect laptops or netbooks of more than 40 watts power consumption! This may lead to overheating or even destruction of the power supply unit.

Useful advices:

Make sure to fully charge the PowerTank as well as the internal battery of your netbook/subnotebook. Then remove the internal battery in order to use up the stored energy of the PowerTank as external power supply first. Later on insert the netbook battery (that is still full) back again and proceed as usual. This line of action guarantees the lowest conversion losses and significantly extends the operational time of your computer. We also advise you to use the power saving functions of your computer such as reduction of the screen brightness and others.

7. Operating the PowerTank XXL with an iPad

Unfortunately it is not possible to recharge the iPad by a standard USB power source. Please use the car cigar jack-to-USB connection plug **G** in combination with the dedicated iPad data- and recharging cable. **F** Both are included in the delivery.

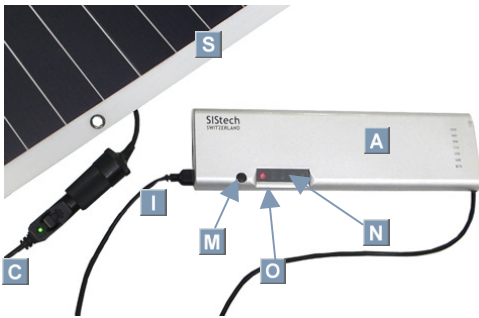

8. Solar operation

To cover power requirements far away from all standard power sources you may not only take advantage of your portable PowerTank XXL **A** but also pay attention to solar accessories available for the PowerTank system. The lightweight SiStech solar panels **S** allow you to replace used energy and have a reliable "plug & play" power source at your fingertips. Once you connect a solar panel to the PowerTank XXL, the storage battery detects the different power source and automatically switches to the low-input-current mode (MPPT). Please note that even a high performance solar charger may take (depending on the intensity of the solar radiation) up to 5 times longer than the recharging process performed at a wall socket.

Important: during the recharge process of the PowerTank XXL no electric consumers may be connected to the storage battery. Please do not constantly expose your PowerTank XXL to the sun, so that it doesn't heat up too much.

9. Capacity indication display

You may check the status of the stored energy by a brief pressure of the ON/OFF button. The lighting up battery symbols can be interpreted in the following way:

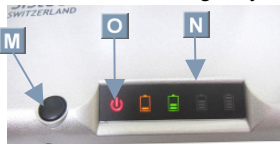

4 LED	80 - 100% capacity available
3 LED	60 - 80% capacity available
2 LED	40 - 60 % capacity available
1 LED	20 - 40 % capacity available
1 LED flashing	less than 10% of the capacity available

Please disconnect all electric consumers and – if possible - immediately recharge the PowerTank XXL again.

10. Technical specifications

Dimensions:	26.5 x 7.8 x 2cm
Weight	570 gr.
Capacity	75 Watt hours (Wh)
Battery type	SWISSBATTERIES / PANASONIC Li-Ion CGR18650CG 9 x 2250 mAh (3P3S)
Protective features	automatic monitoring inhibits overcharge, deep discharge, overload, overheating and short circuits
Input	15 V , max. 3A
Output	15V, max. 5A / 5V, 1A USB
Battery charge time by mains voltage	around 4hours
Battery charge time by a solar module	around 20 hours while exposed to bright sun
Operating temperature	-10 to 45°C

11. Warranty

This quality product is manufactured according to the highest standards. Please pay attention to the very few, but highly important operating instructions within that manual. If you don't follow these instructions, your guarantee claims will expire. Please use original parts only. All cables, plugs and accessories must be provided or otherwise approved by the SiStech AG. SiStech does not take over warranty for any device connected.

12. Notes on disposal

Once this product reaches its operational life span, it must not be disposed of in domestic refuse. Please contact your local waste recycling- and disposal facilities.